

How to change the Bluetooth device name

1. Touch and open the settings menu

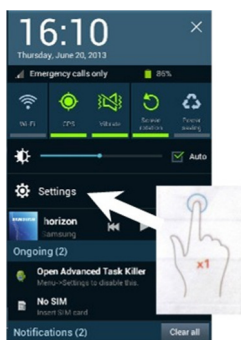

2. Check that Bluetooth is ON

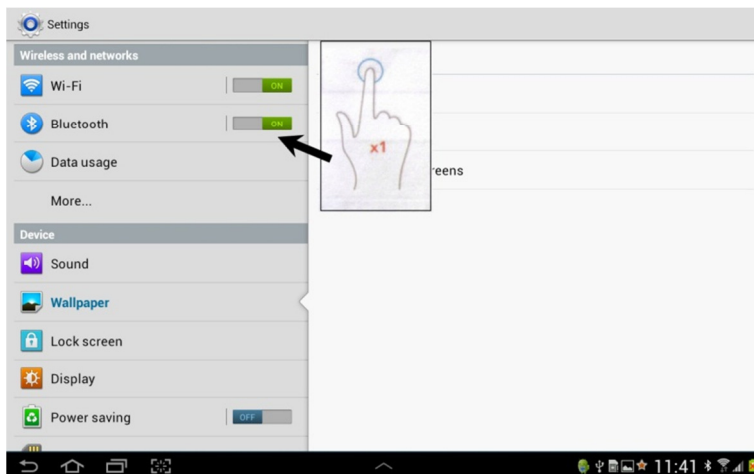

3. Touch **Bluetooth**.
4. Touch the menu in the top right-hand corner.
5. Touch **Device Name**

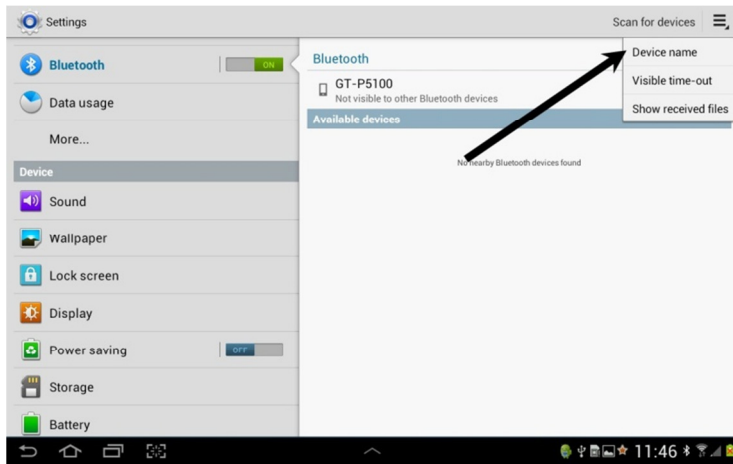

6. Replace the device name by typing the name of your choice. Touch **OK** when done.

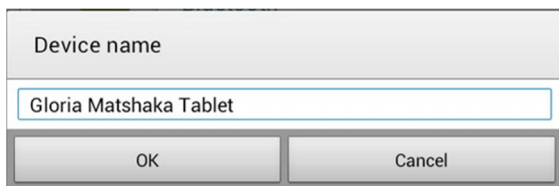
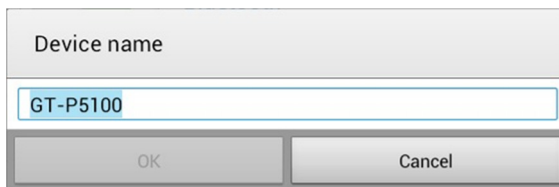

7. Your device name will be updated and recognisable to others.

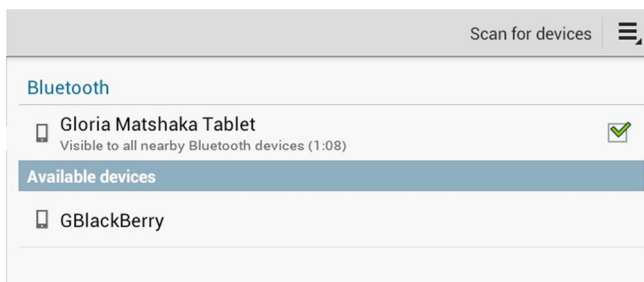

Creative Commons, Attribution, Non-Commercial, Share Alike (South Africa)
ICT4RED (<http://ict4red.blogspot.com>)
Tutorial creator: Maggie Verster